



### Main

Accessory / separate part designation	90° fixing bracket
Product or component type	90° fixing bracket
Accessory / separate part destination	Ø 30 mm sensor
Accessory / separate part category	Fixing accessories
Accessory / separate part type	Bracket

### Complementary

Product compatibility	XX6 diameter 30
Material	Metal

### Packing Units

Unit Type of Package 1	PCE
Number of Units in Package 1	1
Package 1 Height	5.200 cm
Package 1 Width	6.500 cm
Package 1 Length	6.700 cm
Package 1 Weight	77.000 g
Unit Type of Package 2	S01
Number of Units in Package 2	30
Package 2 Height	15.000 cm
Package 2 Width	15.000 cm
Package 2 Length	40.000 cm
Package 2 Weight	2.522 kg

### Offer Sustainability

Sustainable offer status	Green Premium product
REACH Regulation	<a href="#">REACH Declaration</a>
EU RoHS Directive	Pro-active compliance (Product out of EU RoHS legal scope) <a href="#">EU RoHS Declaration</a>
Mercury free	Yes
RoHS exemption information	<a href="#">Yes</a>
Environmental Disclosure	<a href="#">Product Environmental Profile</a>
Circularity Profile	<a href="#">End of Life Information</a>
California proposition 65	WARNING: This product can expose you to chemicals including: Diisononyl phthalate (DINP), which is known to the State of California to cause cancer, and Di-isodecyl phthalate (DIDP), which is known to the State of California to cause birth defects or other reproductive harm. For more information go to <a href="http://www.P65Warnings.ca.gov">www.P65Warnings.ca.gov</a>

### Contractual warranty

Warranty	18 months
----------	-----------

Dimensions

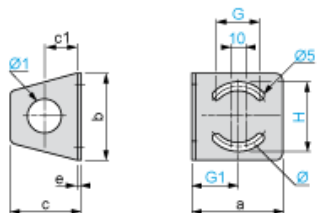

Dimensions in mm

a	b	c	c1	e	H	G	G1	$\varnothing$	$\varnothing 1$
67	65	52	25	3	51	35	33	50	31

Dimensions in in.

a	b	c	c1	e	H	G	G1	$\varnothing$	$\varnothing 1$
2.63	2.56	2.05	0.98	0.12	2.01	1.38	1.30	1.97	1.22